

3265R 空心杯有刷电机

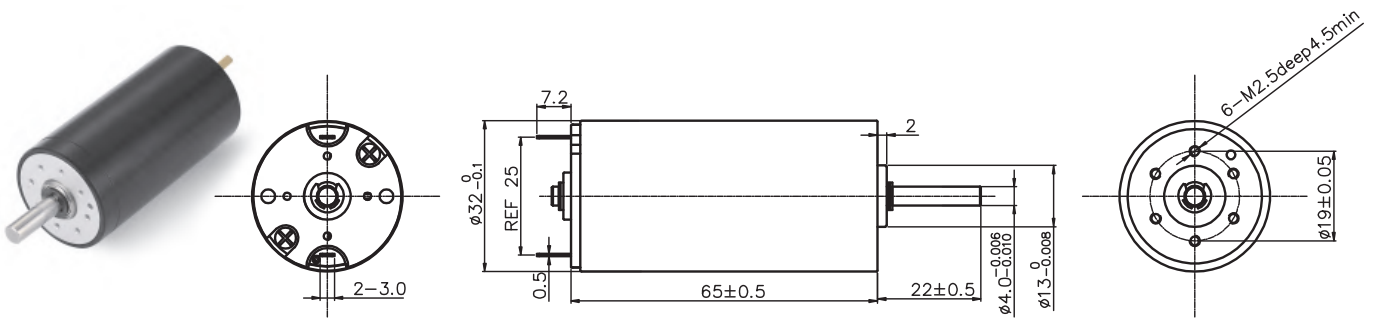

典型应用 Typical Applications: 舵机、智能小机器人

电机参数 (Motor data)		01A	02A	03A	04A
额定电压下数值 (Values at nominal voltage)					
1 额定电压 (Nominal voltage)	V	24	24	24	36
2 空载转速 (No load speed)	rpm	5860	4400	6400	8850
3 空载电流 (No load current)	mA	75	50	77	115
4 额定转速 (Nominal speed)	rpm	5150	3740	5474	8400
5 额定转矩 (最大连续转矩) (Nominal torque)	mNm	50	15	30	40
6 额定电流 (最大连续电流) (Nominal current)	A	1.40	0.33	0.95	1.15
7 堵转转矩 (Stall torque)	mNm	426	98.04	200	797
8 堵转电流 (Stall current)	A	11.11	1.90	5.70	20.90
9 最大效率 (Max efficiency)	%	85	74	80	86
电机常数 (Motor constant)					
10 相间电阻 (Terminal resistance)	Ω	2.16	12.50	4.18	1.72
11 转矩常数 (Torque constant)	mNm/A	38.35	51.07	34.89	38.09
12 速度常数 (Speed constant)	rpm / V	244	183	268	246

其它特性参数 Other characteristic parameters 01A电机曲线图

- 13 环境温度范围 (Ambient temperature) -10 - 40°C
- 14 绕组最高允许温度 (Max permissible winding temperature) 80°C
- 15 最高允许转速 (Max permissible speed) 10000rpm
- 16 电极磁极对数 (Number of the pole pairs) 1
- 17 换向器片数 (Number of the commutator segments) 5
- 18 电机质量 (Weight) 225g

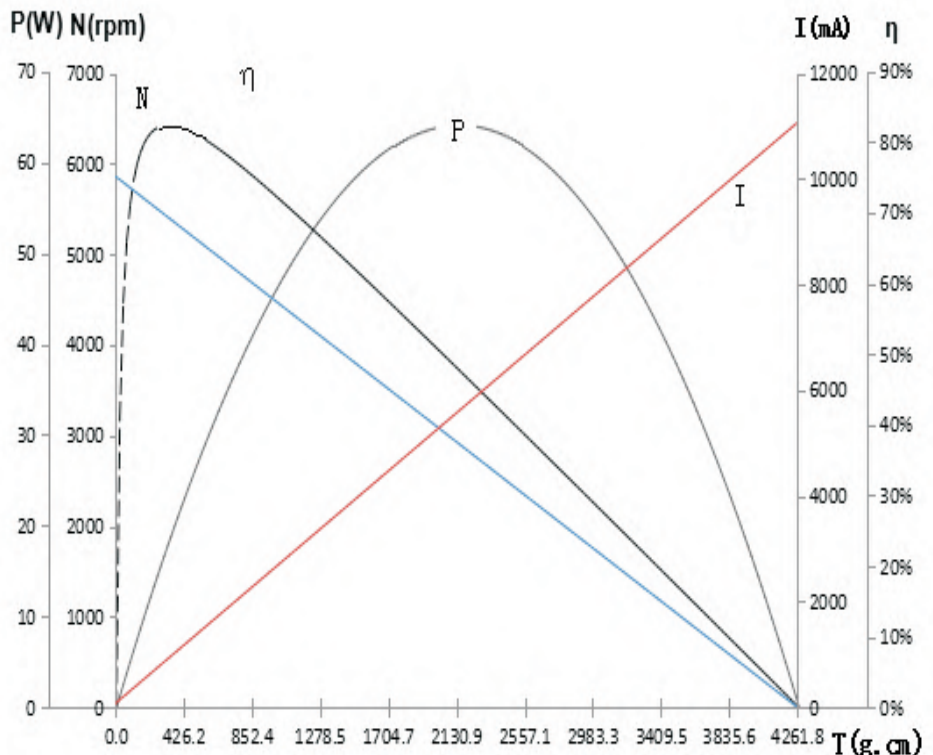

YTK CO.,LTD.
 info@ytk-group.co.jp
 Http://www.ytk-group.co.jp