

UC-260

Carbon-brush motors

Application : Hair Dryer 、 Central Locks

用途：吹風機、中控鎖

DIRECTION OF ROTATION

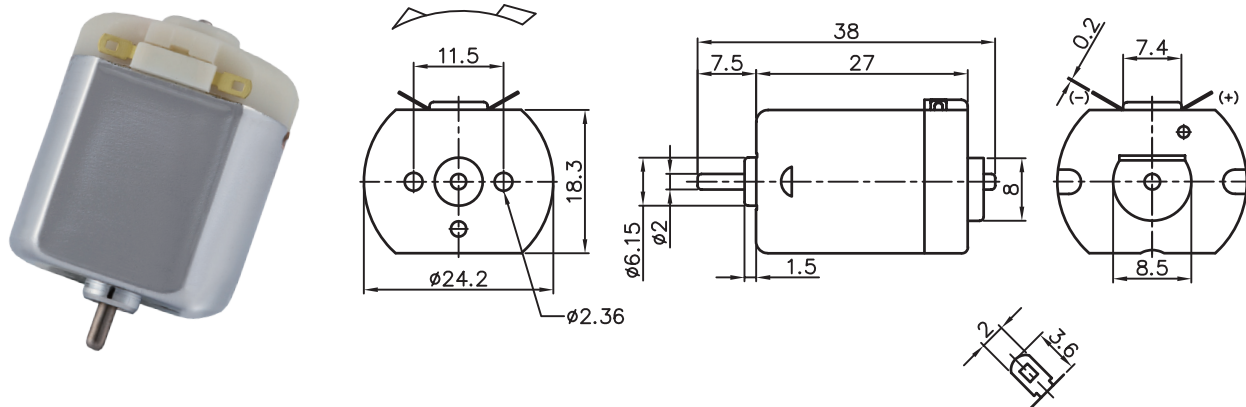

| MODEL | VOLTAGE | | NO LOAD | | AT MAXIMUM EFFICIENCY | | | | | | STALL | | |
|-----------------|-----------------|----------------|---------|---------|-----------------------|---------|--------|--------|------|---------|--------|------|-------|
| | OPERATING RANGE | NOMINAL | SPEED | CURRENT | SPEED | CURRENT | TORQUE | OUTPUT | EFF | CURRENT | TORQUE | | |
| | | | rpm | A | rpm | A | g-cm | mN-m | W | % | A | g-cm | mN-m |
| UC-260-18160-N | 3.0 - 9.0 | 6.0V CONSTANT | 9500 | 0.16 | 7380 | 0.53 | 20 | 1.96 | 1.52 | 48 | 2.05 | 99 | 9.71 |
| UC-260S-09400-N | 12.0 - 24.0 | 12.0V CONSTANT | 6000 | 0.07 | 4520 | 0.15 | 17 | 1.66 | 0.80 | 44 | 0.45 | 70 | 6.86 |
| UC-260S-2665P | 3.0 - 6.0 | 4.5V CONSTANT | 14000 | 0.32 | 10893 | 1.82 | 40 | 3.92 | 4.48 | 55 | 6.76 | 174 | 17.06 |
| UC-260S-12300P | 12.0 - 24.0 | 24.0V CONSTANT | 16500 | 0.10 | 13021 | 0.43 | 45 | 4.44 | 6.06 | 58 | 1.79 | 235 | 23.04 |

馬達的出軸長度及性能參數，EMC 對策可依客人要求做調整，詳情可詢問相關業務人員。
Please inquire your sales representative for output, performance and EMC solution.

