

BLDC4266

Brushless Dc Motor

Application : Water Pump

用途：水泵



DIRECTION OF ROTATION

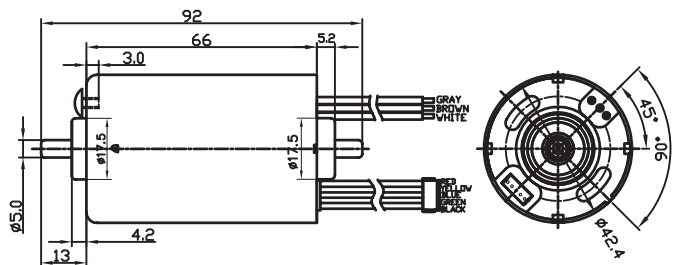
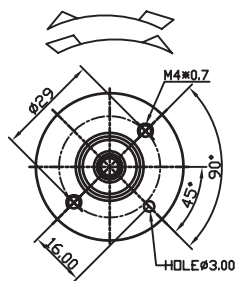

MOTOR LEAD WIRE			HALL SIGNAL WIRE					
WIRE	U	V	W	+5V	HC	HB	HA	GND
COLOUR	GRAY	BROWN	WHITE	RED	YELLOW	BLUE	GREEN	BLACK

WEIGHT : 430g(APPROX)

MODEL	VOLTAGE		NO LOAD		AT MAXIMUM EFFICIENCY					STALL			
	OPERATING RANGE	NOMINAL	SPEED	CURRENT	SPEED	CURRENT	TORQUE	OUTPUT	EFF	CURRENT	TORQUE		
			rpm	A	rpm	A	g-cm	mN-m	W	%	A	g-cm	mN-m
BLDC4266B1W0	-----	12.0V CONSTANT	8700	1.18	7651	5.46	622	60.98	48.87	76	29.19	3971	389.31
BLDC4266B1W0	-----	24.0V CONSTANT	5300	0.30	4484	2.06	892	87.45	41.07	88	11.71	5663	555.20

馬達的出軸長度及性能參數，EMC 對策可依客人要求做調整，詳情可詢問相關業務人員。
Please inquire your sales representative for output, performance and EMC solution.

